

# 2010 Ropes Course Expansion

We are so excited about the ropes course expansion we couldn't wait to tell you about it. The four-element, high ropes course will be expanded this winter and be ready for the summer of 2010 for Middle and Senior Camp and the Counselors-In-Training. Four new elements [top of page] will be added to the high ropes course and a low ropes obstacle course [bottom right] will be constructed exclusively for Junior Camp. The Flying Squirrel can be used for children in all camps [bottom left].



Burma Bridge



Catwalk

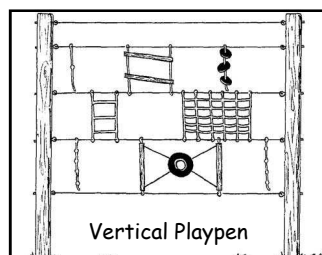

Vertical Playpen



Bosun Chairs & Tires

Four new elements for the high ropes course: [shown above, from the left] Burma Bridge, Catwalk, vertical Playpen and Bosun Chairs and Tires Combo. The Vertical Playpen hangs directly from the Catwalk. Campers can climb the Vertical Playpen to get on to the Catwalk or climb up one of the telephone poles.

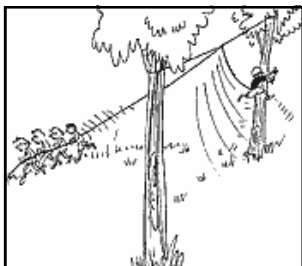

## The Flying Squirrel

Also known as Swing-As-You-Go, The Flying Squirrel is an exciting thrill ride. [Pictured above] The element requires the group to pull their bunkmate to their desired swing height. Upon reaching that height the camper reaches down and pulls the release on their harness and they swing like a pendulum. It is an exciting ride that puts the camper in control. This activity is great for all ages including Junior Camp.



## Junior Camp Low Ropes Challenge Course

Junior Camp is getting a new ropes course to their already plentiful list of weekly activities. The course is only 18 inches off the ground therefore negating the need for belaying campers as pictured below. Counselors and ropes course staff will supervise as four campers at a time climb on the course. Seven new elements will be added in total. Not shown below are the Swing Traverse with chairs and loops and the existing bouldering wall. Campers will be able to move from element to element without touching the ground.

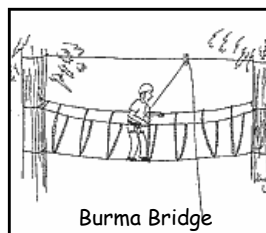

Burma Bridge

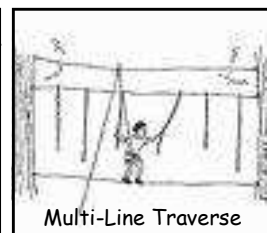

Multi-Line Traverse

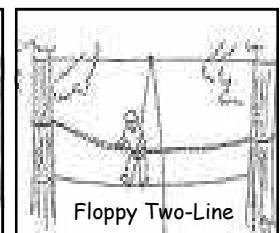

Floppy Two-Line

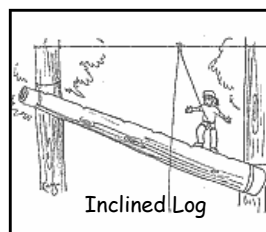

Inclined Log

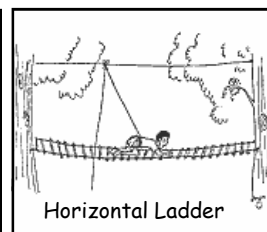

Horizontal Ladder

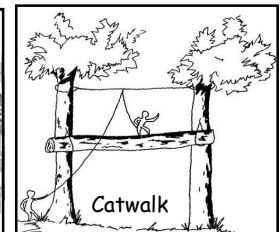

Catwalk

# 2010 Playground Expansion



Front View

We've got big plans for our playground! In January, construction is set to begin on a major playground expansion. In the playground area near the swing sets a new 14-foot high playground area will emerge sitting atop a soft bed of playground safety mulch. Professional installation will be performed by Playworld Systems of Lewisburg, PA.

The new playground joins the swing sets, castle, monkey bars and spiral slide already in the existing play area. The last remaining dirt, gaga court was removed and will be relocated to the sandbox area at the end of Gaga Row. We will also be moving as many other pieces of playground equipment as we can to make one large play area. On the moving list is the sandbox, fire engine, train, slide and tee pee. The system that we chose can be expanded in future years and we have already picked out the pieces that we would like to add. More importantly, the playground will be surrounded by large trees. We have contracted with a tree moving service that will relocate forty existing, mature trees all over the campus including the playground.

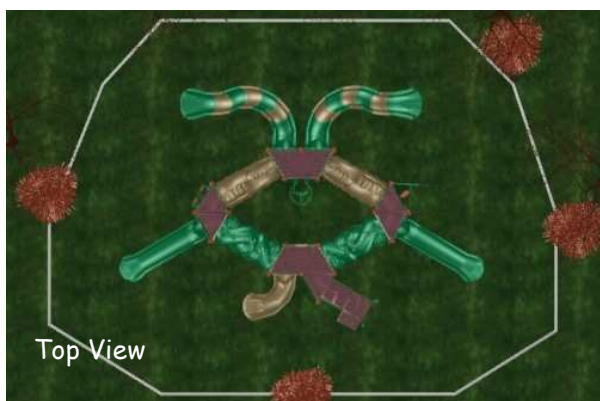

Top View



Rear View